



# RVS-619-NM

## 7" REAR VIEW REPLACEMENT MIRROR MONITOR

Our 7" TFT LCD Rear View Mirror Monitor is a feature-rich monitor that comes with optional grid lines, a built-in speaker, and 3 channel camera capabilities. To control the monitor's functions, either use the sleek touch screen or the included remote control. A 3 port power harness is included with this monitor and it fits all Dodge and Sprinter vehicles from 2010 and onwards. A 3 port power harness is included with this monitor.



### SPECIFICATIONS

Type	TFT LCD
Screen Size	7"
Dot Resolution	800 X 3 (RGB) X 480
Display Format/Contrast	16:09
Display Brightness	400 cd/m <sup>2</sup>
Viewing Angle	90° Min
Video Input	3 channel
Video Source	1Vp-p, 75Ω
Power Supply	DC 12V-24V (+/- 10%)
Power Consumption	5W
Operating Temperature	-10 °C ~ +65 °C
Video System	Auto NTSC/PAL
Overall Dimensions	9" (L) x 4.5" (H) x 1" (D)
Weight	400G
Impact Rating	5G
Dot Pitch	0.192 (H) X 0.1805 (V)
Sync System	Internal





# RVS-619-NM - 7" REAR VIEW REPLACEMENT MIRROR MONITOR MOUNTING INFO



MOUNTS TO WINDSHIELD LIKE REAR VIEW MIRROR



MONITOR MOUNTED ON WINDSHIELD IN A CAB

## SIMPLE MOUNTING IN 2 STEPS

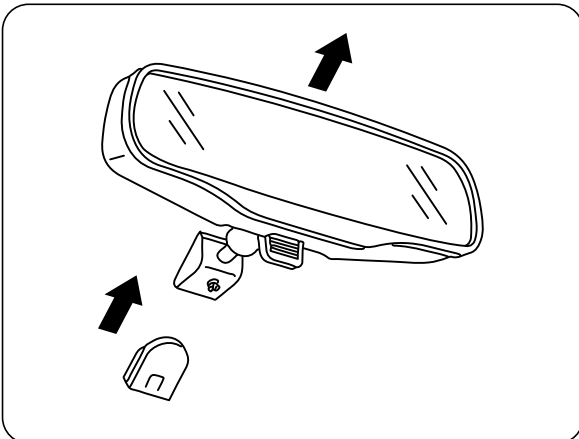

1. REMOVE REAR VIEW MIRROR FROM BUTTON ATTACHED TO WINDSHIELD

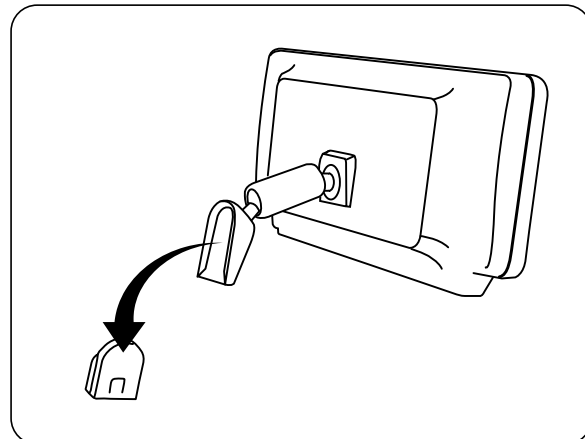

2. SLIDE REAR VIEW MONITOR ONTO WINDSHIELD BUTTON  
(FITS DEFAULT BUTTON IN MOST VEHICLES)